

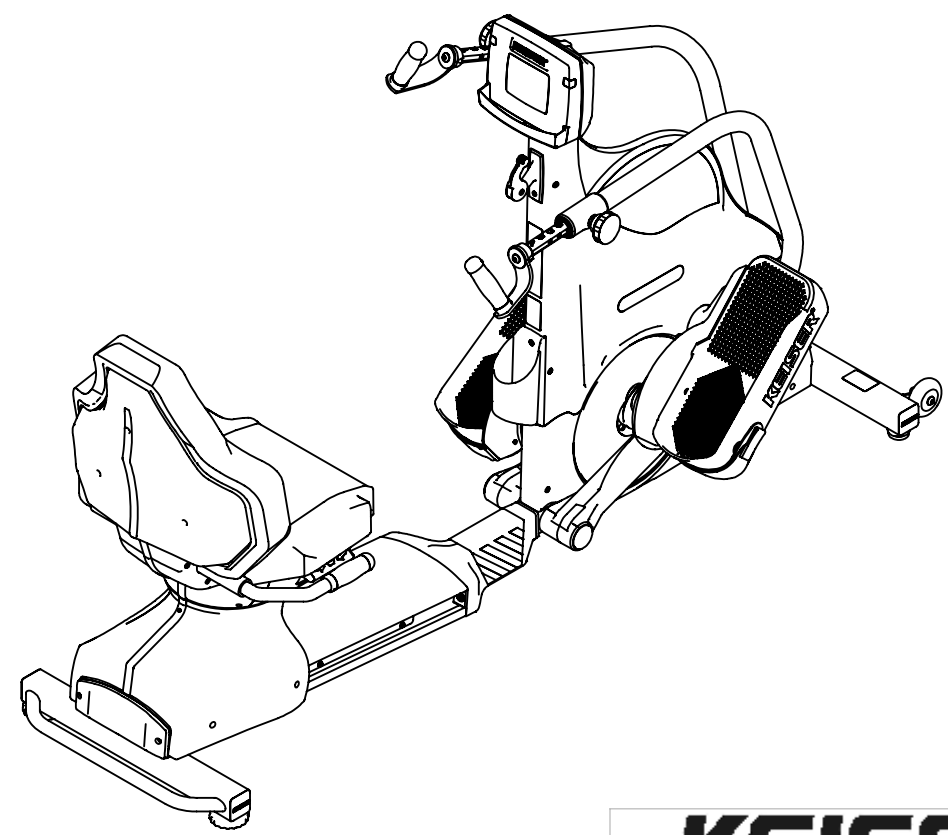



ITEM NO.	QTY.	PART NO.	TITLE	ITEM NO.	QTY.	PART NO.	TITLE
1	3	9062	SCREW - CRFCHMS 10-32 X 1/2 SS	82	1	550808	SA - HUB-FLYWHEEL
2	2	9197	SCREW - HHCS 3/8-16 X 1-1/8 ZP	83	1	555003	FLYWHEEL
3	31	9253	SCREW - CRPHMS #10-32 X 3/16 SS	84	1	555005	HUBCAP - FLYWHEEL
4	4	9257	SCREW - CRPHMS 6-32 X 3/8 ZP	85	1	555008	MAGNET COVER
5	4	9271	SCREW - CRPHMS 4-40 X 5/16 ZP	86	2	555037	SPACER - 032039114
6	1	9287	SCREW - CRPHTS 10-24 X 3/4 SS	87	1	555054	SHIFTER - R
7	4	9291	SCREW - CRPHTS 8 X 1/2 ZP	88	1	555055	SHIFTER - L
8	9	9304	SCREW - CRFCS-PLASTITE 4-20 X 3/8 SS	89	1	555376	DECAL - WARNING-HEART RATE
9	3	9333	SCREW - SBHTS-TF 5/16-18 X 1 ZP	90	1	555381	DECAL - SERIAL NUMBER
10	6	9344	WASHER - FW-USS 5/16 ZP	91	1	555402	BEARING - 6004ZZ-SHIELDED
11	26	9369	WASHER - ACFT 5/16 SS	92	1	555405	SPRING - TORSION
12	5	9500	SCREW - SHCS M6x1 X 10 SS	93	1	555406	BELT - POLY V
13	1	9503	SCREW - SHCS M6x1 X 35 SS	94	1	555419	SCREW - HSPPSS-M10x1.5 X 16 BLK
14	3	9506	SCREW - SBHCS M6-1 X 10 ZP	95	2	555428	SCREW - HWHS-M8X1 X 60 CS
15	26	9511	SCREW - HHCS M8X1.25 X 16 ZP	96	2	555440	SCREW - HWHS-M8X1 X 48 CS
16	2	9516	SCREW - SBHCS M8x1.25 X 45 SS	97	2	555446	WHEEL - 3 IN-W/BUSHING
17	2	9519	NUT-HAN-HC M8x1.25 SS	98	1	555451	SHIFT CABLE - M3X
18	1	9521	NUT - HELN - M8x1.25 SS	99	2	555460	RETAINING RING - INT-42MM
19	1	9522	SCREW - HHCS M8X1.25 X 60 ZP	100	2	565005	CAP - HANDLE TUBE
20	5	9547	SCREW - SHCS M6X1 X 18 SS	101	1	565014	SPACER - R COVER
21	1	9555	PIN - COTTER 1/8 X 7/8 ZP	102	2	565406	ORING - 1 5/8ID X 1 3/4OD X 1/16W
22	1	9556	NUT-HCLN 1/2-20 ZP	103	2	966500	BATTERY - D-CELL
23	2	9558	BUMPER - SCREW STUD-1/4-20 X 1/2 ZP	104	2	990837	STABILIZER - FRAME
24	3	105423	BUMPER - MOLDED GLIDE	105	3	995076	SPACER - BUMPER
25	4	115054	PLUG - 2 IN SQ-KEISER	106	3	995082	CAP - CRANK ARM
26	2	315058	PAD - 1.00 OD X .030	107	1	995324	DECAL - MADE IN THE USA
27	1	520802X	FRONT - DISPLAY	108	1	995375	DECAL - PART 15-FCC
28	1	520807	WA - COMP TO PICKUP				
29	1	520808	COMPUTER - M7i				
30	2	520809	PLUNGER KNOB - M7i				
31	1	520810	PEDAL - L				
32	1	520811	PEDAL - R				
33	1	520826X	CRANK ARM & BELT TENSIONER - R				
34	1	520830	WA - SEAT POSITION SENSOR				
35	1	520834	CUSHION - BACK				
36	1	520837	CUSHION - SEAT				
37	1	520838X	HANDLE - ANTI-ROTATION-L				
38	1	520839X	HANDLE - ANTI-ROTATION-R				
39	1	520840X	ARM - EXTENDED-L				
40	1	520841X	ARM - EXTENDED-R				
41	1	520842X	CRANK ARM & TIMING PULLEY - L				
42	1	520843X	ECCENTRIC & TIMING PULLEY - L				
43	1	520844X	ECCENTRIC & 330MM PULLEY - R				
44	1	520845X	BT MF COVER & CRUSH DECAL - L				
45	1	520846X	BT MF COVER & CRUSH DECAL - R				
46	1	520847X	TOP MF COVER & DOME DECAL - L				
47	1	520848X	TOP MF COVER & DOME DECAL - R				
48	1	520849	CKT BRD - PICKUP				
49	1	520854X	SEAT				
50	1	520855X	TROLLEY				
51	1	520856X	BACK - DISPLAY-TBT				
52	1	520858	WA - SEAT POSITION				
53	1	520859	BOXING KIT - M7i TBT				
54	1	520860	MAGNET HOLDER				
55	1	520911	FRAME - MAIN-TBT				
56	1	520915	CKT BRD - SEAT POSITION				
57	1	521762	PLATE - WASHER-ANTI-ROTATION				
58	1	521763	PLATE - RACK-SELECTOR-FTB				
59	1	521875	PLATE - STOP-REAR				
60	1	525001	SEAT TRACK-EXTR - 635MM				
61	1	525004	COVER - MAINFRAME-AL				
62	1	525009	MOUNT - SHIFTER				
63	4	525011	BUSHING - FLANGE-AL-039067022				
64	1	525074	HOLDER - WATER BOTTLE				
65	1	525093	COVER - SEAT-BACK				
66	1	525094	COVER - TRANSITION-TOP				
67	1	525095	COVER - TRANSITION-BOT				
68	1	525096	COVER - SEAT-BOT-FRONT				
69	1	525097	COVER - SEAT-BOT-REAR				
70	1	525098	COVER - CARRIAGE-L				
71	1	525099	COVER - CARRIAGE-R				
72	1	525100	CAP - EXTR				
73	1	525101	COVER - TRANSITION				
74	1	525376	DECAL - WARNING-USAGE-M7i				
75	1	525378	DECAL - WARNING-PINCH				
76	1	525379	DECAL - SAFETY-TRANSITION				
77	2	525405	CRANK ARM - PEDAL				
78	1	525420	BELT - TIMING				
79	1	525506	MANUAL - USER-M7i RECUMBENT STEPPER				
80	2	543091	HOSE - SPACER-LONG				
81	1	550804	PULLEY - IDLER				

**5210X-SA**



**KEISER®**

2470 South Cherry Ave. Phone: (559) 256-8000  
 Fresno, CA, USA 93706-5004 Fax: (559) 256-8100

THE INFORMATION DISCLOSED HEREIN WAS ORIGINATED BY AND IS THE PROPERTY OF KEISER CORP. AND ALL PATENT, PROPRIETARY, DESIGN, USE, SALE, MANUFACTURING, AND REPRODUCTION RIGHTS THERETO ARE RESERVED BY KEISER CORP.

DIMENSIONS ARE IN INCHES  
 DIMENSIONS IN [ ] ARE MILLIMETERS  
 BREAK SHARP EDGES .005-.015 (.10-.40)  
 MACHINED SURFACE FINISH IS  
 63 MICROINCHES [1.6 MICROMETERS]  
 DO NOT SCALE DRAWING

DRAWN BY: JPR	DATE DRAWN: 4/6/21	CHECKED BY: LC	DATE CHECKED: 6/9/21
---------------	--------------------	----------------	----------------------

MATERIAL:  
 RAW MAT:

REV	ECO	REVISION DESCRIPTION	BY	CKD	DATE
A	3889	REFERENCE PRODUCTION DRAWING REV A	JPR	LC	6/9/21

TITLE: **M7i TOTAL BODY RECUMBENT STEPPER - SA**  
 SHEET **3** OF **3** SCALE: **1:14** DRAWING SIZE: **B** PART#: **5210X-SA**

PRINTED ON: 6/9/2021 SW2006 V5.1

X:\drawings\REVISION\52\_RECUMBENT\_BIKEI