

1921XP-SA

COMMONLY SERVICED COMPONENTS

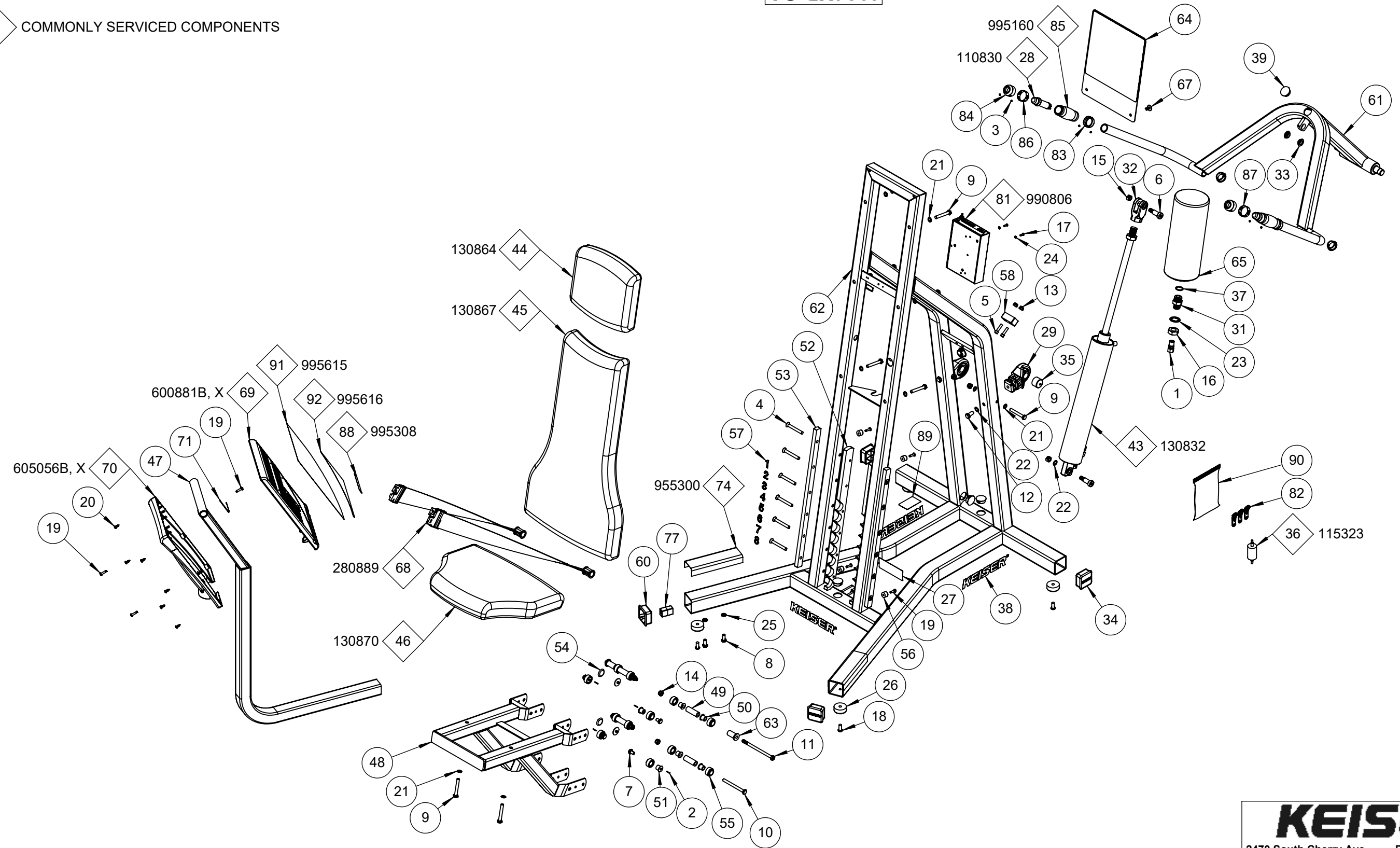

NOTE:

- (1) THIS DRAWING COVERS: 1921BP, 1921PP, AND 1921SP
- (2) FOLLOW ALL TOP LEVEL PROCEDURES

DIMENSIONS ARE IN INCHES
 DIMENSIONS IN [] ARE MILLIMETERS
 BREAK SHARP EDGES .005-.015 [.10-.40]
 MACHINED SURFACE FINISH IS
 63 MICROINCHES [1.6 MICROMETERS]
 DO NOT SCALE DRAWING

KEISER®
 2470 South Cherry Ave. Phone: (559) 256-8000
 Fresno, CA, USA 93706-5004 Fax: (559) 256-8100
 THE INFORMATION DISCLOSED HEREIN WAS ORIGINATED BY
 AND IS THE PROPERTY OF KEISER CORP. AND ALL PATENT,
 PROPRIETARY, DESIGN, USE, SALE, MANUFACTURING, AND
 REPRODUCTION RIGHTS THERETO ARE RESERVED BY KEISER
 CORP.

A	3898	RFP		JC	LC	7/13/21	TITLE: A250 TRICEPS - PWR-SA		
REV	ECO		REVISION DESCRIPTION	BY	CKD	DATE	SHEET 1 OF 2	SCALE: 1:12	DRAWING SIZE: B PART#: 1921XP-SA

X:\drawings\REVISION\19_TRICEP PRINTED ON: 7/13/2021 SW2006 V5.1

ITEM NO.	QTY.	PART NO.	TITLE	ITEM NO.	QTY.	PART NO.	TITLE
1	1	8079	CON - 3/8C X 1/4M	64	1	195416	PLACARD - A250 TRICEP
2	4	9009	PIN SPRING 0063 X 0500 ZP	65	1	255318	TANK - 140 CU IN
3	8	9014	SCREW - HSSS 8-32 X 1/8 SS	66	1	265310	Y CONNECTOR - 1/8 DIA-PL
4	12	9079	SCREW - SCSHCS 5/16-18 X 1 ZP	67	2	265404	PLASTIC RIVET
5	2	9108	SCREW - SHCS 1/4-20 X 1 ZP	68	1	280889	SEAT BELT ASSY
6	2	9127	SCREW - SHSS 1/2 X 1 ZP	69	1	600881X	DISPLAY BOX - 5 WIN
7	4	9174	SCREW - HHCS 5/16-18 X 1/2 ZP	70	1	605056	DISPLAY BOX - BACK
8	2	9175	SCREW - HHCS 5/16-18 X 3/4 ZP	71	1	605428	GROUND CLAMP - DISPLAY
9	10	9179	SCREW - HHCS 5/16-18 X 2-1/4 ZP	72	2	953101	TUBING - .375 OD X .062 W-PE BLK
10	2	9183	SCREW - HHCS 5/16-18 X 3-1/2 ZP	73	1	953108	TUBING - 1/4 URETHANE BLK
11	2	9185	SCREW - HHCS-0313-18 X 5000	74	1	955300	STRIP - PROTECTOR-4 INCH
12	2	9200	SCREW - HHCS 3/8-16 X 3/4 ZP	75	2	962004	CON - 2MM-2-S
13	2	9225	NUT - HELN 1/4-20 ZP	76	4	962005	CON - MOD - P-4P-4C
14	6	9226	NUT - HELN 5/16-18 ZP	77	1	962016	CON - MOD-COUPLER-6-6
15	2	9227	NUT - HRLN 3/8-16 ZP	78	4	962017	CON-MOD-P-6P-6C
16	1	9231	NUT - HJN 3/4-10 ZP	79	1	966701	WIRE - CABLE-4-26 GA
17	2	9272	SCREW - CRPHTS-TF #6-32 X 1/2 SS	80	1	966702	WIRE - CABLE-6-26 GA
18	4	9279	SCREW - SBHTS-TF 5/16-18 X 3/4 ZP	81	1	990806	ASSY - PROCESSOR BOX
19	7	9285	SCREW - CRPHTS 10-24 X 3/4 ZP	82	3	990812	KEY - DATA-CS
20	6	9291	SCREW - CRPHTS 8 X 1/2 ZP	83	2	995000	COLLAR - GRIP
21	12	9353	WASHER - ACFT-5/16 ZP	84	2	995001	CAP - GRIP W HOLE
22	3	9355	WASHER - FW-ACFT-3/8 SS	85	2	995160	GRIP - MOLDED
23	1	9364	WASHER - ITLW 3/4 ZP	86	1	995300	DECAL - TB-PLUS
24	2	9366	WASHER - ITLW #6 ZP	87	1	995301	DECAL - TB-MINUS
25	2	9389	WASHER - ITLW 5/16 ZP	88	1	995308	DECAL - SEAT-POWER
26	4	105423	BUMPER - MOLDED GLIDE	89	1	995324	DECAL - MADE IN THE USA
27	1	105443	DECAL - SERIAL NUMBER	90	1	995418	BAG - 4 X 6 X 4MIL-ZIP LOCK
28	2	110830	ASSY - TB VALVE-DIG	91	1	995615	PLACARD - ENG-POWER-BLK
29	2	110894	BEARING ASSY	92	1	995616	PLACARD - ENG-KEY-RED
30	1	110897	ASSY - QD-MALE				
31	1	115000	BUSHING - TANK				
32	1	115005	CLEVIS - CYLINDER-2-1/2				
33	2	115051	BEARING - FLANGE-.5 ID				
34	3	115054	PLUG - 2 IN SQ-KEISER				
35	2	115067	CAP - Ø 1 X 3/4				
36	1	115323	FILTER - IN LINE				
37	1	115333	O-RING - .943 X .737 X .103				
38	3	115372	DECAL - KEISER LOGO-1 1/4" RED				
39	8	115404	PLUG - HOLE-1 DIA				
40	17	115423	TIE - 8 IN-PL BLK				
41	1	115429	PLASTIC TIE - 10" RED				
42	1	120803	FLOW RESTRICTOR				
43	1	130832	ASSY - EC-2.5 X 12				
44	1	130864	CUSHION - HEAD-CURVED				
45	1	130867	CUSHION - BACK-CURVED				
46	1	130870	CUSHION - SEAT-CURVED				
47	1	130933	WELDT - DISPLAY MT				
48	1	130934	WELDT - FRM-SEAT				
49	4	132181	TUBE - ROLLER				
50	8	132200	AXLE				
51	4	132201	AXLE - THREADED				
52	2	135005	SEAT RACK				
53	2	135006	SEAT RAIL				
54	4	135055	STEM BUMPER				
55	12	135060	ROLLER				
56	4	135076	PLASTIC BUMPER				
57	1	135306	DECAL - SEAT-1-10				
58	1	165421	STOP - EA-URETHANE				
59	1	170891	ASSY - MUFFLER-LONG				
60	1	175051	2 SQ. BUSHING				
61	1	190907	EX ARM - A250				
62	1	190921	MAIN FRM				
63	2	195001	SEAT BELT ADAPTER .3125				

1921XP-SA

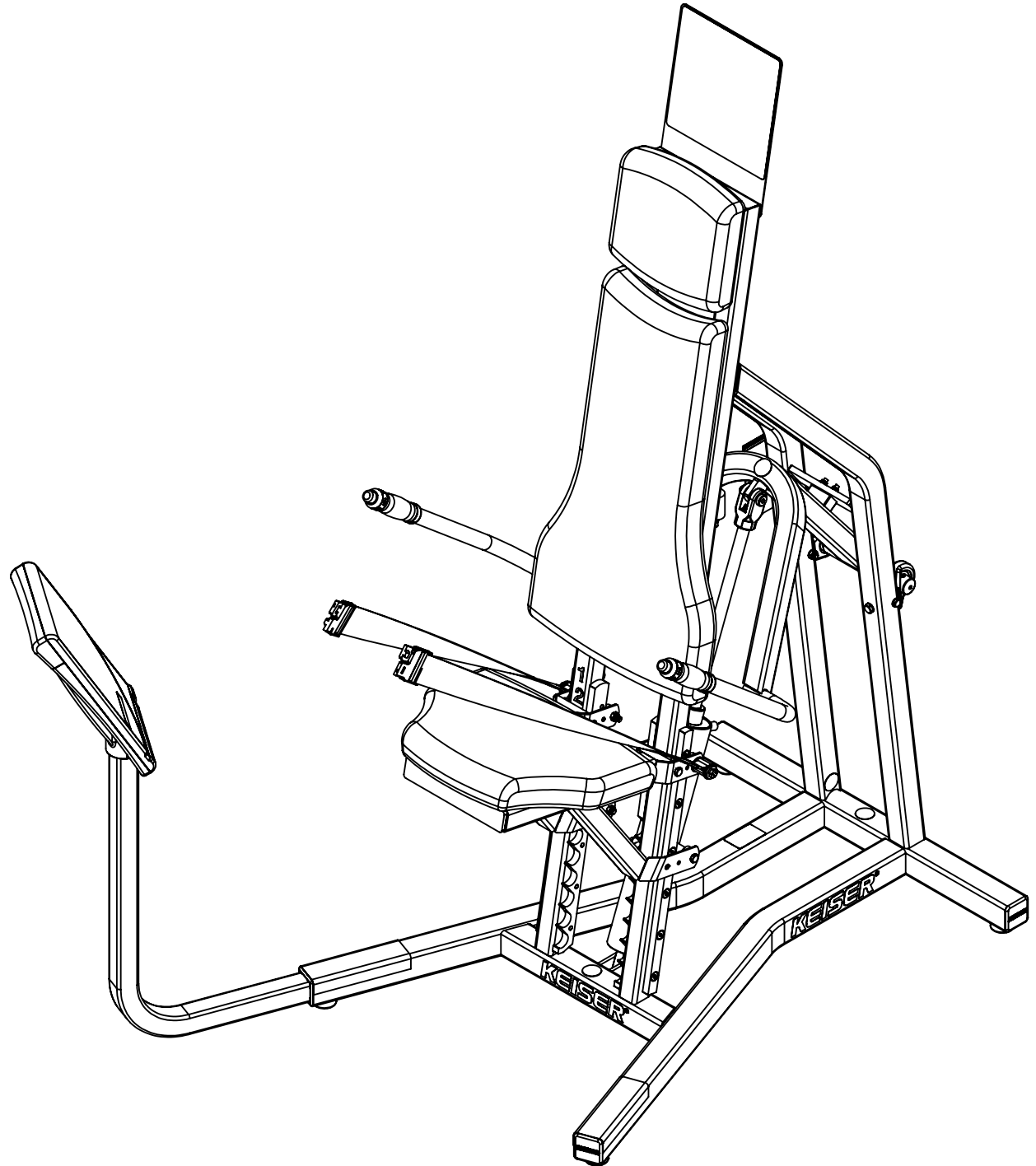

KEISER®

2470 South Cherry Ave. Phone: (559) 256-8000
 Fresno, CA, USA 93706-5004 Fax: (559) 256-8100

THE INFORMATION DISCLOSED HEREIN WAS ORIGINATED BY AND IS THE PROPERTY OF KEISER CORP. AND ALL PATENT, PROPRIETARY, DESIGN, USE, SALE, MANUFACTURING, AND REPRODUCTION RIGHTS THERETO ARE RESERVED BY KEISER CORP.

DIMENSIONS ARE IN INCHES
 DIMENSIONS IN [] ARE MILLIMETERS
 BREAK SHARP EDGES .005-.015 [.10-.40]
 MACHINED SURFACE FINISH IS
 63 MICROINCHES [1.6 MICROMETERS]
 DO NOT SCALE DRAWING

DRAWN BY: JC	DATE DRAWN: 5/20/21	CHECKED BY: LC	DATE CHECKED: 7/13/21
--------------	---------------------	----------------	-----------------------

MATERIAL: _____
 RAW MAT: _____
 MASS (Kg): _____

REV	ECO	REVISION DESCRIPTION	BY	CKD	DATE
A	3898	RFP	JC	LC	7/13/21

TITLE: **A250 TRICEPS - PWR-SA**
 SHEET **2** OF **2** SCALE: **1:10** DRAWING SIZE: **B** PART#: **1921XP-SA**

PRINTED ON: 7/13/2021 SW2006 V5.1

X:\drawings_REVISION\19_TRICEP