

1222XP-SA

# COMMONLY SERVICED COMPONENTS

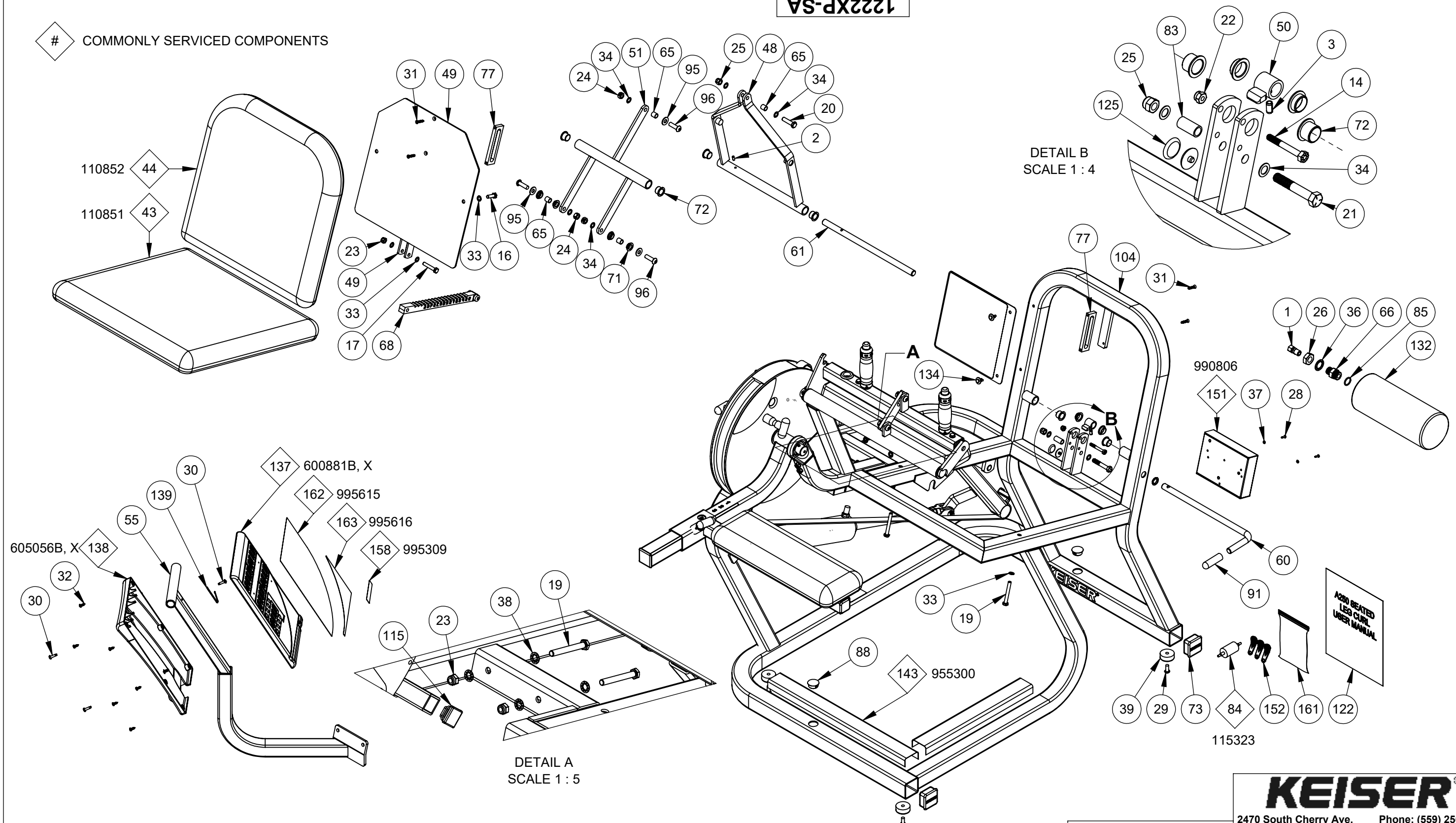

NOTE:  
 (1) THIS DRAWING COVERS: 1222BP, 1222PP AND 1222SP  
 (2) FOLLOW ALL TOP LEVEL PROCEDURES

REV	ECO	REVISION DESCRIPTION	BY	CKD	DATE
A	3877	RFP	BJU	LC	7/2/21

DIMENSIONS ARE IN INCHES  
 DIMENSIONS IN [ ] ARE MILLIMETERS  
 BREAK SHARP EDGES .005-.015 [ .10-.40 ]  
 MACHINED SURFACE FINISH IS  
 63 MICROINCHES [ 1.6 MICROMETERS ]  
 DO NOT SCALE DRAWING

**KEISER®**  
 2470 South Cherry Ave. Phone: (559) 256-8000  
 Fresno, CA, USA 93706-5004 Fax: (559) 256-8100  
 THE INFORMATION DISCLOSED HEREIN WAS ORIGINATED BY  
 AND IS THE PROPERTY OF KEISER CORP. AND ALL PATENT,  
 PROPRIETARY, DESIGN, USE, SALE, MANUFACTURING, AND  
 REPRODUCTION RIGHTS THERETO ARE RESERVED BY KEISER  
 CORP.

DRAWN BY: BJU	DATE DRAWN: 4/28/21	CHECKED BY: LC	DATE CHECKED: 7/2/21
MATERIAL:		RAW MAT:	
TITLE: <b>A250 LEG CURL W/RANGE LIMITER - PWR-SA</b>			
SHEET 1 OF 3	SCALE: 1:10	DRAWING SIZE: B	PART#: 1222XP-SA

X:\drawings\REVISION12\_LEG\_CURL PRINTED ON: 7/2/2021 SW2006 V5.1



ITEM NO.	QTY.	PART NO.	TITLE	ITEM NO.	QTY.	PART NO.	TITLE	<b>1222XP-SA</b>			
1	1	8079	CON - 3/8C X 1/4M	64	1	112242	CLAMP DISC	ITEM NO.	QTY.	PART NO.	TITLE
2	2	9001	PIN SPRING - 3/16 X 1/2	65	6	113040	SHOULDER SLEEVE - 1/2 X 1/2	119	1	125309	DECAL - R.O.M. POSITION
3	1	9003	PIN SPRING - 1/4 X 1/2	66	1	115000	BUSHING - TANK	120	1	125370	DECAL - STARTING POS CHART
4	8	9014	SCREW - HSSS 8-32 X 1/8 SS	67	1	115005	CLEVIS - CYLINDER-2-1/2	121	1	125416	PLACARD - A250 SEATED LEG CURL
5	1	9015	SET SCREW - HSSS #8-32 X 3/16 BLK	68	1	115010	RACK - MACHINED	122	1	125501	MANUAL - USER - A250 SEATED LEG CURL
6	3	9030	SCREW - HSSS 1/4-20 X 3/8 ZP	69	2	115034	ROLLER	123	1	130832	ASSY - EC-2.5 X 12
7	2	9095	SCREW - SHCS 0250-28 X 0750 ZP	70	1	115036	THREADED INSERT - 5/8 X 3/8 SS	124	2	135050	BEARING - FLANGE-1" ID
8	4	9098	SCREW - SHCS 1/4-20 X 1/2 ZP	71	14	115051	BEARING - FLANGE-.5 ID	125	2	135055	STEM BUMPER
9	1	9101	SCREW - SHCS 5/16-18 X 1 ZP	72	9	115052	BEARING - FLANGE-.625 ID	126	1	135056	CAP - 1.500 SQ-PL
10	2	9105	SCREW - SHCS 5/16-24 X 7/8	73	2	115054	PLUG - 2 IN SQ-KEISER	127	1	143190	SADDLE - C-BORE
11	5	9116	SCREW - SHCS #10-32 X 5/8 ZP	74	3	115056	BEARING - FLANGE-.625 ID SHORT	128	5	165421	STOP - EA-URETHANE
12	2	9127	SCREW - SHSS 1/2 X 1 ZP	75	1	115059	CAP - 1-3/4 SQ	129	1	170891	ASSY - MUFFLER-LONG
13	2	9151	SCREW - HHCS 1/4-20 X 3/4 ZP	76	2	115067	CAP - Ø 1 X 3/4	130	2	172180	PLUNGER
14	1	9152	SCREW - HHCS 1/4-20 X 2 ZP	77	2	115072	GUIDE / BEARING	131	2	175500	SPRING - PLUNGER
15	1	9155	SCREW - HHCS 1/2-20 X 1 3/4 ZP	78	2	115077	BUSHING	132	1	255318	TANK - 140 CU IN
16	2	9176	SCREW - HHCS 5/16-18 X 1 ZP	79	2	115078	SPACER	133	1	265310	Y CONNECTOR - 1/8 DIA-PL
17	1	9177	SCREW - HHCS 5/16-18 X 1-3/4 ZP	80	1	115082	SPACER - 00375 ID	134	2	265404	PLASTIC RIVET
18	6	9179	SCREW - HHCS 5/16-18 X 2-1/4 ZP	81	1	115300	DECAL - STARTING POSITION	135	1	265419	BELT PULLEY
19	6	9180	SCREW - HHCS 5/16-18 X 2-1/2 ZP	82	3	115301	FINGER WARNING DECAL	136	2	555059	KNOB - T-BLACK
20	1	9203	SCREW - HHCS 3/8-16 X 1 1/2 ZP	83	1	115314	TUBE - SLEEVE	137	1	600881X	DISPLAY BOX - 5 WIN
21	1	9206	SCREW - HHCS 3/8-16 X 2 1/4 ZP	84	1	115323	FILTER - IN LINE	138	1	605056	DISPLAY BOX - BACK
22	1	9225	NUT - HELN 1/4-20 ZP	85	1	115333	O-RING - .943 X .737 X .103	139	1	605428	GROUND CLAMP - DISPLAY
23	8	9226	NUT - HELN 5/16-18 ZP	86	2	115372	DECAL - KEISER LOGO-1 1/4" RED	140	1	950510	KEVLAR BELT 1
24	7	9227	NUT - HRLN 3/8-16 ZP	87	1	115377	DECAL - POSITION	141	1	953101	TUBING - .375 OD X .062 W-PE BLK
25	2	9228	NUT - HELN 3/8-16 ZP	88	2	115404	PLUG - HOLE-1 DIA	142	1	953108	TUBING - 1/4 URETHANE BLK
26	1	9231	NUT - HJN 3/4-10 ZP	89	7	115423	TIE - 8 IN-PL BLK	143	2	955300	STRIP - PROTECTOR-4 INCH
27	2	9246	NUT - HELN 10-24 ZP	90	1	115424	SNAP-IN NYLINER	144	1	955304	TAPE - .010 UHMW-4IN BLK
28	2	9272	SCREW - CRPHTS-TF #6-32 X 1/2 SS	91	1	115427	GRIP - 0500 X 2500	145	2	962004	CON - 2MM-2-S
29	4	9279	SCREW - SBHTS-TF 5/16-18 X 3/4 ZP	92	1	115429	PLASTIC TIE - 10" RED	146	4	962005	CON - MOD - P-4P-4C
30	15	9285	SCREW - CRPHTS 10-24 X 3/4 ZP	93	2	115430	PLASTIC TIE - 3" BLK	147	1	962016	CON - MOD-COUPLER-6-6
31	4	9288	SCREW - CRPHTS TF 10-24 X 1 ZP	94	1	115436	TAPPERED RUBBER DONUT	148	4	962017	CON-MOD-P-6P-6C
32	6	9291	SCREW - CRPHTS 8 X 1/2 ZP	95	5	115450	WASHER - FW .88 X .39 X .07 NP	149	1	966701	WIRE - CABLE-4-26 GA
33	18	9353	WASHER - ACFT-5/16 ZP	96	5	115451	SCREW - SBHCS 3/8-16 X 1-1/4 NP	150	1	966702	WIRE - CABLE-6-26 GA
34	10	9355	WASHER - FW-ACFT-3/8 SS	97	1	115463	GROMMET - 075106013	151	1	990806	ASSY - PROCESSOR BOX
35	2	9360	WASHER - ACFT 1/2 SS	98	1	120800	ADJUST RACK	152	3	990812	KEY - DATA-CS
36	1	9364	WASHER - ITLW 3/4 ZP	99	1	120803	FLOW RESTRICTOR	153	2	995000	COLLAR - GRIP
37	2	9366	WASHER - ITLW #6 ZP	100	1	120851	THIGH PAD CUSHION	154	2	995001	CAP - GRIP W HOLE
38	4	9389	WASHER - ITLW 5/16 ZP	101	1	120912	EX ARM - RANGE LMTR CHRМ	155	2	995160	GRIP - MOLDED
39	4	105423	BUMPER - MOLDED GLIDE	102	1	120913	L - RANGE-COVER	156	1	995300	DECAL - TB-PLUS
40	1	110804	ASSY-KNOB-1.25	103	1	120917	R RANGE COVER WHT	157	1	995301	DECAL - TB-MINUS
41	1	110805	ASSY - KNOB-0776	104	1	120918	MAIN FRM	158	1	995309	DECAL - SEAT, LEG, ROM, ROM-POWER
42	2	110830	ASSY - TB VALVE-DIG	105	1	120921	WELDED SFT	159	1	995324	DECAL - MADE IN THE USA
43	1	110851	SEAT BOTTOM CUSHION A250	106	1	120922	KNEE PAD ARM BLK	160	1	995381	DECAL - SERIAL NUMBER - STRENGTH
44	1	110852	SEAT BACK CUSHION A250	107	1	120923	TENSION ADJUSTER	161	1	995418	BAG - 4 X 6 X 4MIL-ZIP LOCK
45	1	110860	LEG SUPPORT CUSHION	108	1	121822	STOP PLATE	162	1	995615	PLACARD - ENG-POWER-BLK
46	2	110894	BEARING ASSY	109	1	121827	SMALL KEY	163	1	995616	PLACARD - ENG-KEY-RED
47	1	110897	ASSY - QD-MALE	110	1	121840	BUMPER SPACER				
48	1	110909	SEAT BACK PIVOT	111	1	121898	END RANGE DISC				
49	1	110912	SEAT BACK	112	1	121899	LARGE KEY				
50	1	110916	PAWL	113	1	122040	FINGER GUARD				
51	1	110919	SEAT FR PIVOT	114	1	125051	SPACER				
52	1	110924	LEVER ARM	115	1	125052	CAP - 1 SQ				
53	1	110925	LEG UPHOL MT	116	1	125055	VINYL RING				
54	1	110928	BELT MT	117	1	125056	SLOTTED LINK				
55	1	110932	WELDT - DISPLAY MT	118	1	125300	DECAL - STOP POSITION				
56	1	111896	CLAMP W HOLE								
57	2	112160	SHAFT - .5 X 1.69 SS								
58	1	112161	SHAFT - .5 X 2.31 SS								
59	1	112162	SPACER								
60	1	112181	PAWL HANDLE								
61	1	112182	SEAT BACK PIVOT SFT								
62	1	112183	PIVOT SHAFT SS								
63	1	112206	RANGE LIMITER STOP ZP								

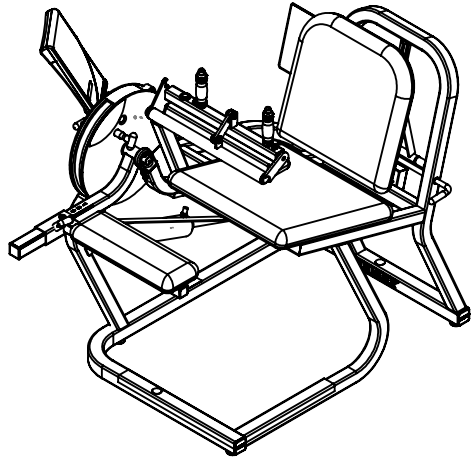

DIMENSIONS ARE IN INCHES  
 DIMENSIONS IN [ ] ARE MILLIMETERS  
 BREAK SHARP EDGES .005-.015 [.10-.40]  
 MACHINED SURFACE FINISH IS  
 63 MICROINCHES [1.6 MICROMETERS]  
 DO NOT SCALE DRAWING

**KEISER®**  
 2470 South Cherry Ave. Phone: (559) 256-8000  
 Fresno, CA, USA 93706-5004 Fax: (559) 256-8100  
 THE INFORMATION DISCLOSED HEREIN WAS ORIGINATED BY  
 AND IS THE PROPERTY OF KEISER CORP. AND ALL PATENT,  
 PROPRIETARY, DESIGN, USE, SALE, MANUFACTURING, AND  
 REPRODUCTION RIGHTS THERETO ARE RESERVED BY KEISER  
 CORP.

DRAWN BY: BJU	DATE DRAWN: 4/28/21	CHECKED BY: LC	DATE CHECKED: 7/2/21
MATERIAL:			
RAW MAT:			
TITLE: <b>A250 LEG CURL W/RANGE LIMITER - PWR-SA</b>			
SHEET <b>3</b> OF <b>3</b>		SCALE: <b>1:24</b>	DRAWING SIZE: <b>B</b> PART#: <b>1222XP-SA</b>

REV	ECO	REVISION DESCRIPTION	BY	CKD	DATE
A	3877	RFP	BJU	LC	7/2/21

PRINTED ON: 7/2/2021 SW2006 V5.1

X:\drawings\REVISION\12\_LEG\_CURL