

1030X-SA

COMMONLY SERVICED COMPONENTS

PARTS ASSOCIATED WITH A SERVICE ASSEMBLY

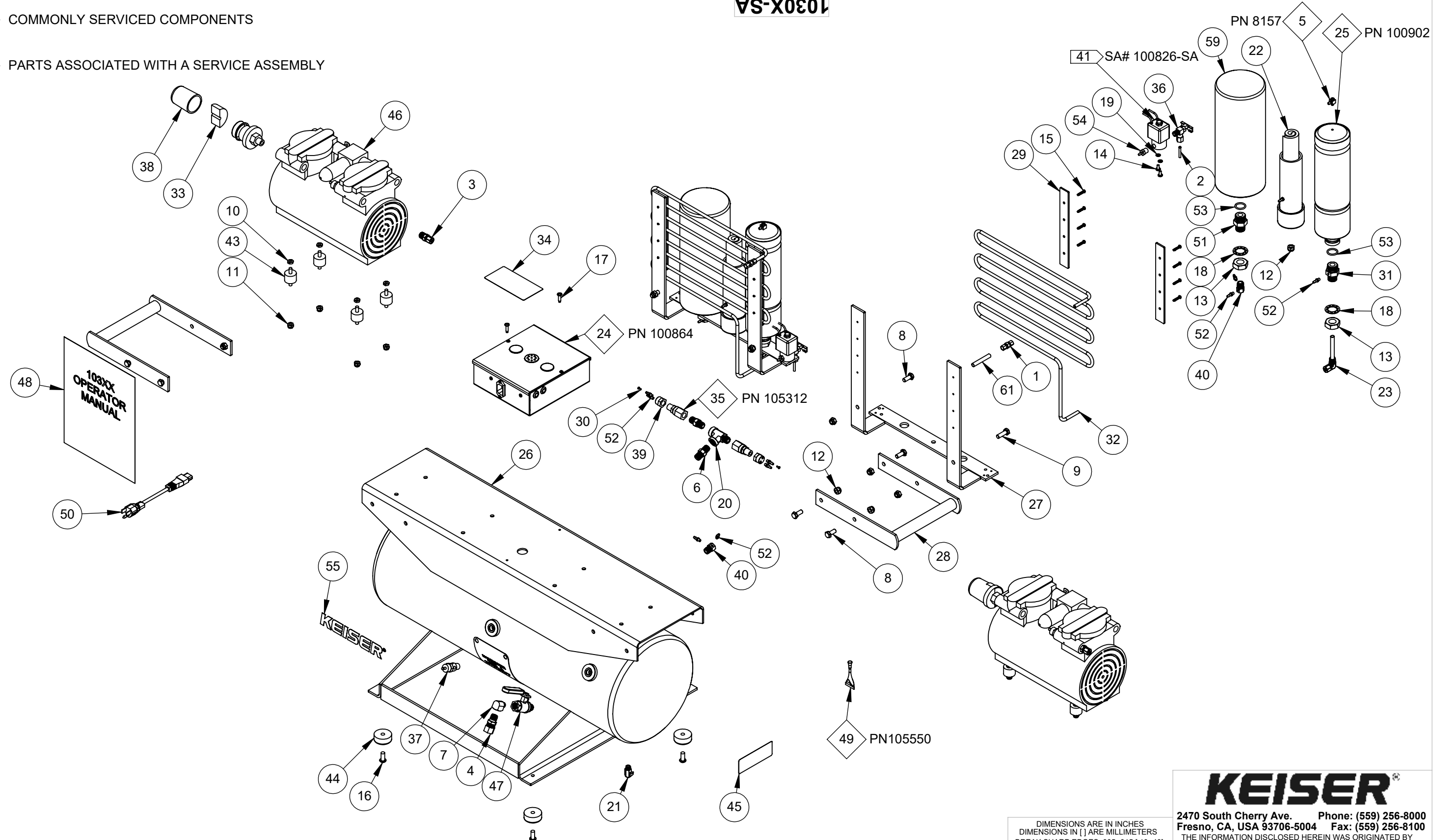

NOTE:
 (1) 1030X-SA COVERS THE FOLLOWING MODELS: 1030B, 1030P, 1030X
 (2) SEND LOCTITE 242 PN 105550 FOR FITTING REPLACEMENTS AS NEEDED

| REV | ECO | DESCRIPTION | BY | CKD | DATE |
|-----|------|-------------|-----|-----|----------|
| A | 3806 | RFP | LMG | LC | 10/19/20 |

DIMENSIONS ARE IN INCHES
 DIMENSIONS IN [] ARE MILLIMETERS
 BREAK SHARP EDGES .005-.015 (.10-.40)
 MACHINED SURFACE FINISH IS
 63 MICROINCHES [1.6 MICROMETERS]
 DO NOT SCALE DRAWING

KEISER[®]
 2470 South Cherry Ave. Phone: (559) 256-8000
 Fresno, CA, USA 93706-5004 Fax: (559) 256-8100
 THE INFORMATION DISCLOSED HEREIN WAS ORIGINATED BY
 AND IS THE PROPERTY OF KEISER CORP. AND ALL PATENT,
 PROPRIETARY, DESIGN, USE, SALE, MANUFACTURING, AND
 REPRODUCTION RIGHTS THERETO ARE RESERVED BY KEISER
 CORP.

| | | | |
|--|----------------------|-----------------|------------------------|
| DRAWN BY: LMG | DATE DRAWN: 10/15/20 | CHECKED BY: LC | DATE CHECKED: 10/19/20 |
| MATERIAL: RAW MAT: | | | |
| TITLE: COMPRESSOR - 10 GAL-115V 60H-SA | | SCALE: 1:8 | |
| SHEET 1 OF 2 | | DRAWING SIZE: B | PART#: 1030X-SA |

PRINTED ON: 10/23/2020SW2006 V5.1

X:\drawings\APPROVED\10_COMPRESSORS\

| ITEM NO. | QTY. | PART NO. | TITLE | ITEM NO. | QTY. | PART NO. | TITLE |
|----------|------|----------|--------------------------------------|----------|------|----------|----------------------------------|
| 1 | 2 | 8000 | UNION - 1/4C | 64 | 8 | 962038 | CON - PIN-14-20 AWG-CRIMP-TIN |
| 2 | 2 | 8053 | TUBE - INSERT-1/8 | 65 | 2 | 962039 | CON - PIN-GR-14-20 AWG-CRIMP-TIN |
| 3 | 2 | 8076 | CON - 1/4C X 1/4M | 66 | 4 | 962064 | CON - CLOSED END - 18 TO 10 AWG |
| 4 | 1 | 8081 | CON - 0500C X 0250M | 67 | 1 | 966709 | WIRE - SINGLE-1-16GA-GR/YEL |
| 5 | 2 | 8157 | ELBOW - 10-32M X 1/4B | | | | |
| 6 | 2 | 8351 | NIPPLE - HN 1/4 | | | | |
| 7 | 1 | 8401 | ELBOW - 1/4F X 1/4M | | | | |
| 8 | 8 | 9175 | SCREW - HHCS 5/16-18 X 3/4 ZP | | | | |
| 9 | 2 | 9176 | SCREW - HHCS 5/16-18 X 1 ZP | | | | |
| 10 | 8 | 9221 | NUT - HJN 1/4-20 ZP | | | | |
| 11 | 8 | 9225 | NUT - HELN 1/4-20 ZP | | | | |
| 12 | 12 | 9226 | NUT - HELN 5/16-18 ZP | | | | |
| 13 | 4 | 9231 | NUT - HJN 3/4-10 ZP | | | | |
| 14 | 4 | 9261 | SCREW - CRPHMS 10-32 X 3/8 SS | | | | |
| 15 | 16 | 9274 | SCREW - CRPHTS-TF 6-32 X 3/4 BLK | | | | |
| 16 | 4 | 9279 | SCREW - SBHTS-TF 5/16-18 X 3/4 ZP | | | | |
| 17 | 2 | 9285 | SCREW - CRPHTS 10-24 X 3/4 ZP | | | | |
| 18 | 4 | 9364 | WASHER - ITLW 3/4 ZP | | | | |
| 19 | 4 | 9379 | WASHER - ITLW 10 | | | | |
| 20 | 1 | 9988 | STREET TEE 1/4 | | | | |
| 21 | 1 | 9995 | VALVE - TANK DRAIN | | | | |
| 22 | 2 | 100803 | DRAIN TUBE ASSY | | | | |
| 23 | 2 | 100863 | ELBOW - INLET ASSY 10GAL | | | | |
| 24 | 1 | 100864 | ELEC BOX ASSEMBLY - 115-230V | | | | |
| 25 | 2 | 100902 | DRYER ASSY. | | | | |
| 26 | 1 | 100924 | TANK - 10GAL QUIET | | | | |
| 27 | 2 | 100925 | WELDT - TANK BRACKET | | | | |
| 28 | 2 | 100926 | HANDLE - TANDEM COMP | | | | |
| 29 | 4 | 101809 | BRKT - PRECOOLER | | | | |
| 30 | 2 | 105009 | FLOW RESTRICTOR .036 | | | | |
| 31 | 2 | 105011 | BUSHING - TANK-DRILLED | | | | |
| 32 | 2 | 105062 | COOLING COIL - 1030 | | | | |
| 33 | 2 | 105166 | FOAM - INTAKE MUFFLER | | | | |
| 34 | 1 | 105307 | DECAL - INFORMATION-115V | | | | |
| 35 | 2 | 105312 | CHECK VALVE #227 W/VITON | | | | |
| 36 | 2 | 105315 | DRAIN COCK | | | | |
| 37 | 1 | 105321 | PRES.RELIEF VALVE-150 PSI | | | | |
| 38 | 2 | 105337 | MUFFLER INLET ASSY | | | | |
| 39 | 2 | 105373 | CAP - 1/4 W/ 2 10-32 HOLES | | | | |
| 40 | 3 | 105376 | ELBOW - 1/4NPT W/2 10-32 | | | | |
| 41 | 2 | 105405 | SOLENOID VALVE-ALLENNAIR MODEL G120V | | | | |
| 42 | 2 | 105421 | RING TERMINAL - #10-14 GA | | | | |
| 43 | 8 | 105422 | VIBRATION ISOLATER - 1/4 | | | | |
| 44 | 4 | 105423 | BUMPER - MOLDED GLIDE | | | | |
| 45 | 1 | 105443 | DECAL - SERIAL NUMBER | | | | |
| 46 | 2 | 105448 | COMPRESSOR - MOTOR-075HP | | | | |
| 47 | 1 | 105467 | 1/4 MXF BALL VALVE 200PSI | | | | |
| 48 | 1 | 105515 | MANUAL - OPERATOR 103XX | | | | |
| 49 | 1 | 105550 | THREAD SEALANT - LOCTITE 242 | | | | |
| 50 | 1 | 105811 | POWER CORD - NORTH AMERICA | | | | |
| 51 | 2 | 115000 | BUSHING - TANK | | | | |
| 52 | 12 | 115019 | BARBED CONN - 1/4 X 10-32 | | | | |
| 53 | 4 | 115333 | O-RING - .943 X .737 X .103 | | | | |
| 54 | 2 | 115346 | BARB - 1/8 X 1/8 | | | | |
| 55 | 1 | 115372 | DECAL - KEISER LOGO-1 1/4" RED | | | | |
| 56 | 1 | 115423 | TIE - 8 IN-PL BLK | | | | |
| 57 | 21 | 115430 | PLASTIC TIE - 3" BLK | | | | |
| 58 | 2 | 125420 | PLASTIC TIE - 14.5 BLK | | | | |
| 59 | 2 | 255318 | TANK - 145 CU IN | | | | |
| 61 | 1 | 953108 | TUBING - 1/4 URETHANE BLK | | | | |
| 61 | 1 | 953112 | TUBING TEF ZEUS 1/4 - FEP | | | | |
| 62 | 2 | 962036 | CON - ML-2-P-TH | | | | |
| 63 | 2 | 962037 | CON - ML-3-P-TH | | | | |

1030X-SA

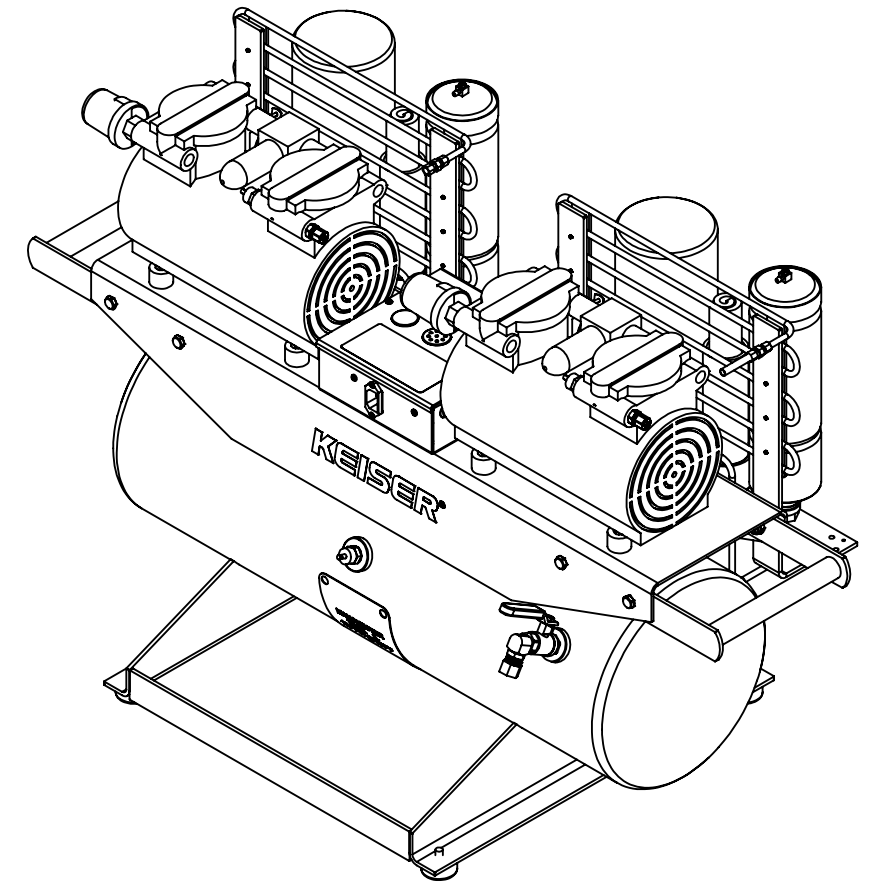

PRINTED ON: 10/23/2020SW2006 V5.1

X:\drawings\APPROVED\10_COMPRESSORS\

DIMENSIONS ARE IN INCHES
DIMENSIONS IN [] ARE MILLIMETERS
BREAK SHARP EDGES .005-.015 [.10-.40]
MACHINED SURFACE FINISH IS
63 MICROINCHES [1.6 MICROMETERS]
DO NOT SCALE DRAWING

KEISER[®]
2470 South Cherry Ave. Phone: (559) 256-8000
Fresno, CA, USA 93706-5004 Fax: (559) 256-8100
THE INFORMATION DISCLOSED HEREIN WAS ORIGINATED BY
AND IS THE PROPERTY OF KEISER CORP. AND ALL PATENT,
PROPRIETARY, DESIGN, USE, SALE, MANUFACTURING, AND
REPRODUCTION RIGHTS THERETO ARE RESERVED BY KEISER
CORP.

| | | | | | | | |
|-----------|------|-------------|----------------------|-------------|-----|---------------|--|
| DRAWN BY: | LMG | DATE DRAWN: | 10/15/20 | CHECKED BY: | LC | DATE CHECKED: | 10/19/20 |
| MATERIAL: | | | | | | | |
| RAW MAT: | | | | | | | |
| A | 3806 | RFP | | LMG | LC | 10/19/20 | TITLE: COMPRESSOR - 10 GAL-115V 60H-SA |
| REV | ECO | | REVISION DESCRIPTION | BY | CKD | DATE | SHEET 2 OF 2 SCALE: 1:8 DRAWING SIZE: B PART#: 1030X-SA |