

1031X-SA

COMMONLY SERVICED COMPONENTS

PARTS ASSOCIATED WITH A SERVICE ASSEMBLY

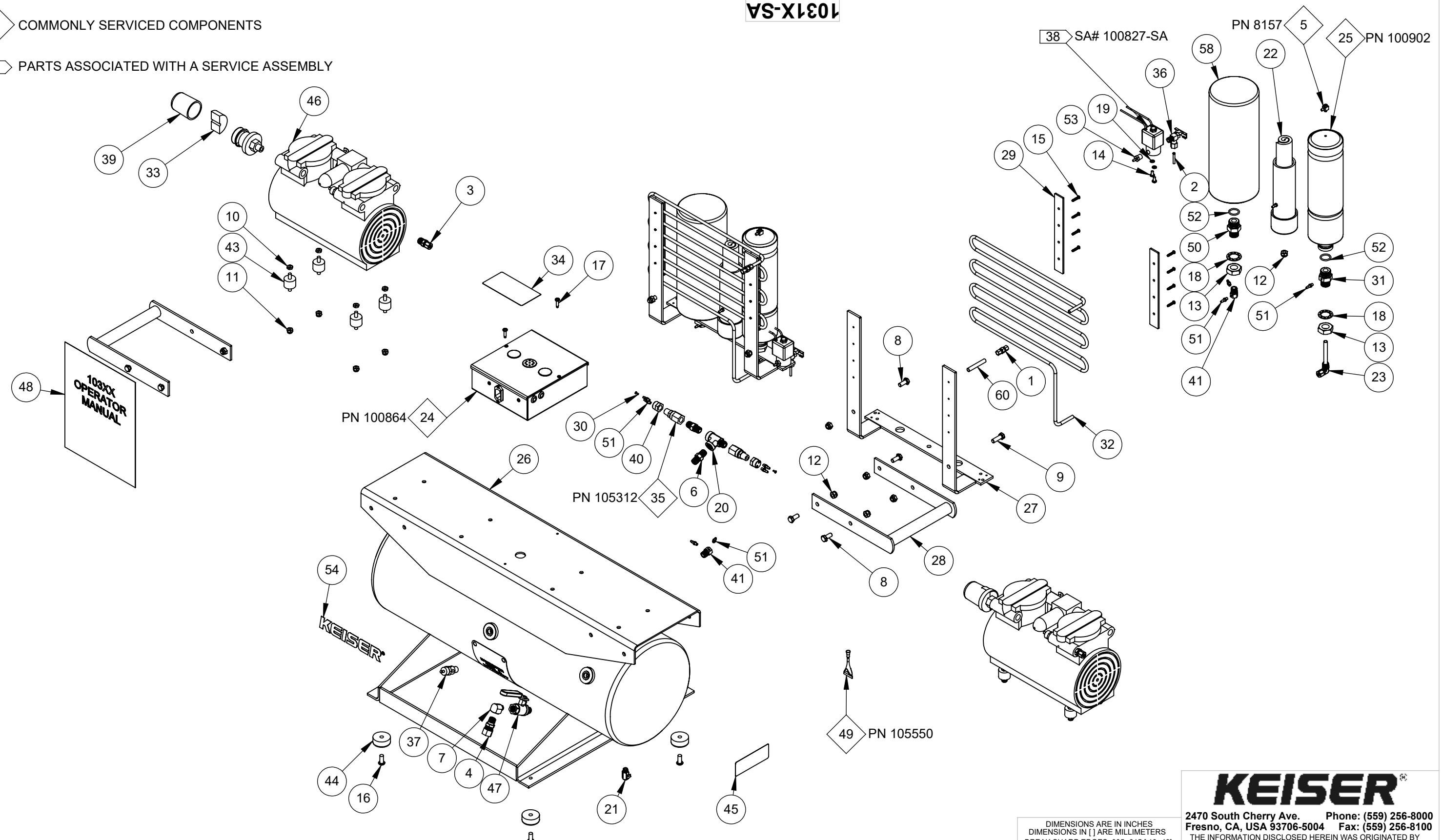

NOTE:
 (1) 1031X-SA COVERS THE FOLLOWING MODELS: 1031B, 1031P, 1031X
 (2) SEND LOCTITE 242 PN 105550 FOR FITTING REPLACEMENTS AS NEEDED

			DIMENSIONS ARE IN INCHES DIMENSIONS IN [] ARE MILLIMETERS BREAK SHARP EDGES .005-.015 [.10-.40] MACHINED SURFACE FINISH IS 63 MICROINCHES [1.6 MICROMETERS] DO NOT SCALE DRAWING			KEISER 2470 South Cherry Ave. Phone: (559) 256-8000 Fresno, CA, USA 93706-5004 Fax: (559) 256-8100 THE INFORMATION DISCLOSED HEREIN WAS ORIGINATED BY AND IS THE PROPERTY OF KEISER CORP. AND ALL PATENT, PROPRIETARY, DESIGN, USE, SALE, MANUFACTURING, AND REPRODUCTION RIGHTS THERETO ARE RESERVED BY KEISER CORP.		
DRAWN BY:	LMG	DATE DRAWN:	10/15/20	CHECKED BY:	LC	DATE CHECKED:	10/19/20	
MATERIAL:								
RAW MAT:								
A	3806	RFP		LMG	LC	10/19/20	TITLE: COMPRESSOR - 10 GAL-230V 50H-SA	
REV	ECO		REVISION DESCRIPTION	BY	CKD	DATE	SHEET 1 OF 2 SCALE: 1:8 DRAWING SIZE: B PART#: 1031X-SA	

X:\drawings\APPROVED\10_COMPRESSORS\ PRINTED ON: 10/23/2020SW2006 V5.1

