

ITEM NO.	QTY.	PART NO.	TITLE	ITEM NO.	QTY.	PART NO.	TITLE
1	1	8079	CONN - 3/8C X 1/4M	84	1	600881	DISPLAY BOX 5 - WIN
2	1	8085	LUER - MALE-1/8 BARB	85	1	605060	DISPLAY BOX - BACK-MODIFIED
3	4	9014	SET SCREW - HSSS 8-32 X 1/8 SS	86	1	605428	GROUND CLAMP - DISPLAY
4	2	9024	RING - RETAINING-EXT-17MM	87	1	953108	TUBING - 1/4 URETHANE BLK
5	2	9065	SCREW - SFCHCS 8-32 X 7/8 BLK	88	1	954212	ROPE - 5mm POLYESTER/NYLON
6	8	9096	SCREW - SHCS 1/4-20 X 2 1/2 ZP	89	1	955300	STRIP - PROTECTOR-4 INCH
7	2	9097	SCREW - SHCS 10-32 X 1/2 ZP	90	2	962004	CONNECTOR - 2 MM
8	2	9098	SCREW - SHCS 1/4-20 X 1/2 ZP	91	4	962005	CON - MOD-P-4P-4C
9	1	9127	SCREW - SHSS 1/2-13 X 1 ZP	92	2	962017	CON - MOD-P-6P-6C
10	2	9135	SCREW - SHSS 5/16-18 X 3/4 ZP	93	1	966701	CABLE - FLAT-4 WIRE 26 GA
11	1	9153	SCREW - HHCS 1/4-20 X 2-1/4 ZP	94	1	966702	WIRE - CABLE-6-26 GA
12	5	9157	SCREW - HHCS 1/4-20 X 1 GR5 ZP	95	1	990806	ASSY - PROCESSOR BOX
13	2	9161	SCREW - HHCS 1/4-20 X 2-3/4 ZP	96	3	990812	KEY - DATA-CS
14	1	9163	SCREW - HHCS 1/4-20 X 1-3/4 ZP	97	2	995001	CAP - GRIP W HOLE
15	2	9164	SCREW - HHCS 1/4-20 X 1-1/2 ZP	98	1	995300	DECAL - TB-PLUS
16	2	9200	SCREW - HHCS 3/8-16 X 3/4 ZP	99	1	995301	DECAL - TB-MINUS
17	4	9201	SCREW - HHCS 3/8-16 X 1 ZP	100	1	995418	BAG - 4 X 6 X 4MIL-ZIP LOCK
18	11	9225	NUT - HELN 1/4-20 ZP	101	1	995611	DECAL - KEISER LOGO-4" RED
19	1	9227	NUT - HRLN 3/8-16 ZP	102	1	995615	PLACARD - ENG-POWER-BLK
20	1	9231	NUT - HJN 3/4-10 ZP	103	1	995616	PLACARD - ENG-KEY-RED
21	8	9242	NUT - HEJN 1/4-20 ZP				
22	2	9248	NUT - HMSN 6-32 ZP				
23	8	9252	SCREW - CRPHMS 1/4-20 X 1/4 ZP				
24	2	9255	SCREW - CRPHMS 6-32 X 1/4 ZP				
25	4	9272	SCREW - CRPHTS-TF #6-32 X 1/2 SS				
26	3	9285	SCREW - CRPHTS 10-24 X 3/4 ZP				
27	6	9291	SCREW - CRPHTS 8 X 1/2 ZP				
28	2	9292	NUT - HEJN #10-32 ZP				
29	2	9321	NUT - HEJN 8-32 ZP				
30	2	9331	SCREW - CRTHMS 10-24 X 3/8				
31	2	9335	NUT - 10-24 X 5/8 COMBO HEAD				
32	2	9341	WASHER-ETLW #10 ZP				
33	6	9355	WASHER - FW-ACFT-3/8 SS				
34	2	9357	WASHER - ITLW 1/4 ZP				
35	1	9364	WASHER - ITLW 3/4 ZP				
36	2	9389	WASHER - ITLW 5/16 ZP				
37	2	9391	WASHER - FW-ACFT 1/4 SS				
38	1	105443	DECAL - SERIAL NUMBER				
39	2	110830	ASSY - TB VALVE-DIG				
40	1	115000	BUSHING - TANK				
41	1	115323	FILTER - IN LINE				
42	1	115333	O-RING - .943 X .737 X .103				
43	5	115423	TIE - 8 IN-PL BLK				
44	1	115429	PLASTIC TIE - 10 RED				
45	4	135055	STEM BUMPER				
46	1	170891	ASSY - MUFFLER-LONG				
47	2	17180	PLUNGER				
48	2	175500	SPRING - PLUNGER				
49	2	215502	RETAINING RING - 1.70 OD				
50	2	225400	BEARING - 6203ZZ-SHIELDED				
51	1	255318	TANK - 145 CU IN				
52	1	285310	Y CONNECTOR - 1/8 DIA-PL				
53	2	300807	ASSY - HANDLE GRIP				
54	1	300826	CYL & PULLEY BRKT - POWER				
55	1	300925	WELDT - POWER MODULE-FT				
56	1	300930	WELDT - TPL PULLEY BRKT-FT				
57	1	300932	WELDT - DISPLAY MT				
58	1	301701	PLATE - ACC HOOKS-FT-L				
59	1	301702	PLATE - ACC HOOKS-FT-R				
60	2	301830	PLATE - BACK-ADJ ELBOW				
61	1	302057	COVER - BACK-FT				
62	2	302184	SHAFT - COUNTER WT				
63	2	305004	THROAT - JEWEL BLOCK				
64	2	305007	TUBE - ELBOW-FT				
65	2	305016	ELBOW - MOLDED-LH				
66	2	305017	ELBOW - MOLDED-RH				
67	2	305018	HOUSING - L PULLEY-SNGL				
68	2	305019	HOUSING - R PULLEY-SNGL				
69	2	305021	ARM - LOCK				
70	2	305029	CLEVIS - INV CAST				
71	1	305060	COVER - TOP-FT				
72	20	305062	BUSHING - 028067029				
73	1	305064	BUMPER - PULLEY BRKT				
74	12	305065	PULLEY - 2.500 DIA-MOLDED				
75	2	305370	DECAL-HANDLE RELEASE				
76	2	305411	LINK - HANDLE				
77	4	305417	BALL - 0.750-CRM ST GR 25				
78	2	305437	BUMPER - CLEVIS				
79	1	305607	DECAL - RH PLATE-PLUNGER ADJ				
80	1	305608	DECAL - INF SERIES-FT & TT				
81	1	305609	DECAL - LH PLATE-PLUNGER ADJ				
82	2	315070	HOLDER - TRANS ROPE GUIDE				
83	2	555059	KNOB - T-BLACK				

**3020XP**

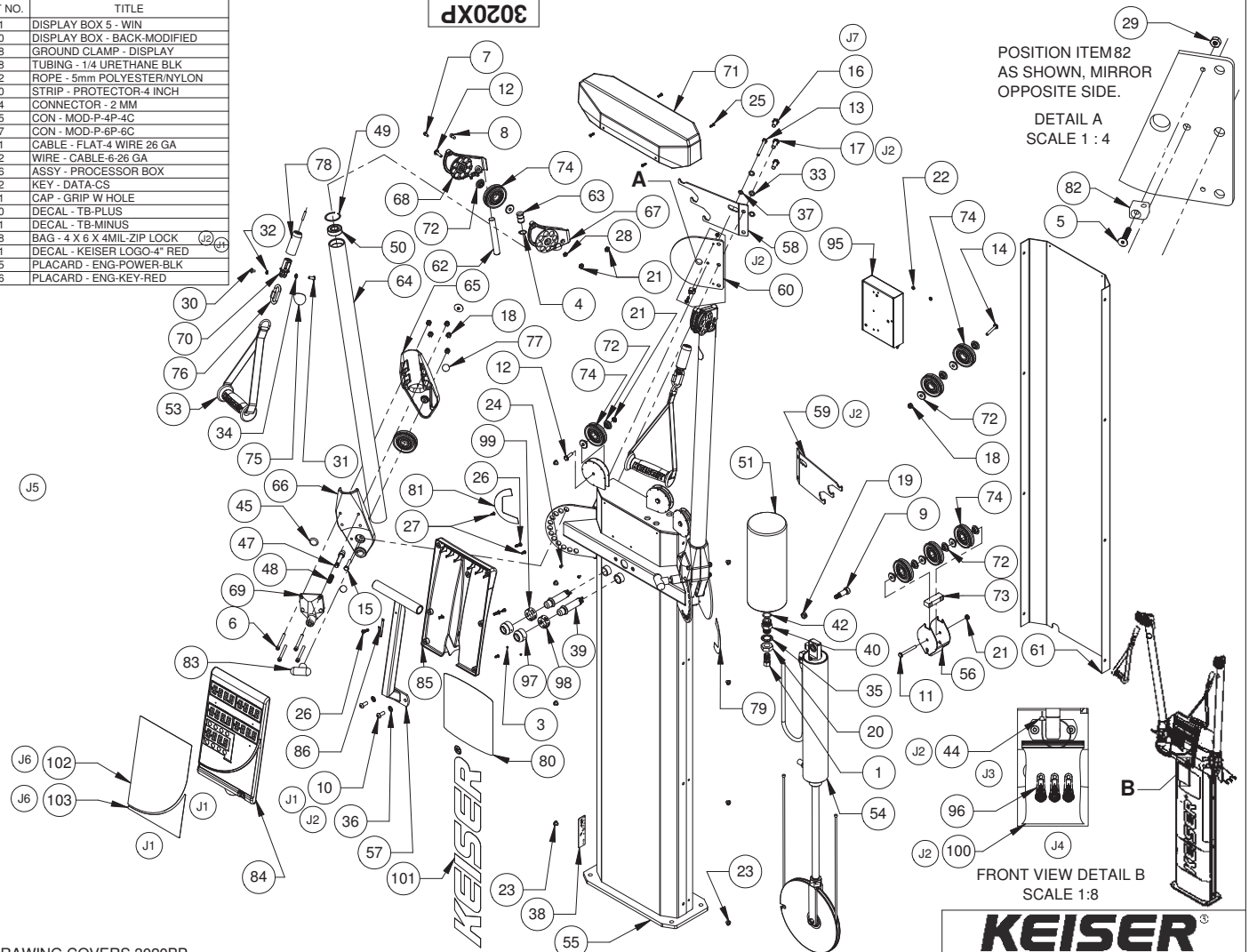

NOTES:  
 (1) THIS DRAWING COVERS 3020BP, 3020PP AND 3020XP  
 (2) SEE WINMAGI FOR PAINT SPECS

REV	ECO	REVISION DESCRIPTION	BY	CKD	DATE
J	3429	(6) WAS HEXAGONAL BALLOON (7) WAS QTY 6	JPR	DLK	11/3/16
J	3429	301702, 995418 (3) REM VIEW (4) ADD VIEW (5) REM NOTE	JPR	DLK	11/3/16
J	3429	(1) REM 9121, 295603, 995600 (2) ADD 9135, 9201, 115429, 301701,	JPR	DLK	11/3/16

DIMENSIONS ARE IN INCHES  
 DIMENSIONS IN [ ] ARE MILLIMETERS  
 BREAK SHARP EDGES .005-.015 [10-.40]  
 MACHINED SURFACE FINISH IS  
 63 MICRONS [1.6 MICROMETERS]

DO NOT SCALE DRAWING

DRAWN BY: JAM DATE DRAWN: 1/5/09 CHECKED BY: MCA DATE CHECKED: 3/22/10

MATERIAL:  
 RAW MAT:

TITLE: **FUNCTIONAL TRAINER-PWR**

SHEET 1 OF 4 SCALE: 1:12 DRAWING SIZE: B PART#: 3020XP



2470 South Cherry Ave. Phone: (559) 256-8000  
 Fresno, CA, USA 93706-5004 Fax: (559) 256-8100

THE INFORMATION DISCLOSED HEREIN WAS ORIGINATED BY AND IS THE PROPERTY OF KEISER CORP. AND ALL PATENT, PROPRIETARY DESIGN, USE, SALE, MANUFACTURING, AND REPRODUCTION RIGHTS THERETO ARE RESERVED BY KEISER CORP.